



Thelma Grove, TW11

A two bedroom, ground floor garden flat located in the heart of Teddington.

ESTATE & AGENT

— Tailored, local and personal —

Thelma Grove, TW11

£500,000 Guide Price, Leasehold

Offered with no onward chain and vacant possession, the sale of this two bedroom, ground floor garden flat represents a rare and exciting opportunity for its next owner. The flat is located in a quiet cul-de-sac in the heart of Teddington, moments from the High Street and Train Station.

The accommodation could benefit from being updated, with much potential on offer and briefly comprises: entrance porch leading onto a living room, an inner hallway with storage cupboard, kitchen with range of fitted wall and base units, a spacious shower room/w.c., double bedroom with fitted wardrobes and a second double bedroom with patio doors leading directly to the garden.

Externally to the front of the property there is an allocated parking space with side access leading to the rear of the property with an inviting mature garden comprising of lawn, flower beds, mature shrubs and garden shed.

Thelma Grove is located just off Blackmore's Grove providing very easy access to a variety of local shops, amenities, cafes, restaurants and transport links in popular Teddington.

The lease is 199 years from 14th November, 1966. Ground rent is £12.60 per year and we have been advised that there is no service charge. The property is close to Royal Bushy Park as well as the Lensbury and River Thames. Viewing comes highly recommended. EPC: D, Richmond Council Tax Band: C.



- Vacant possession
- No onward chain
- Approx. 141 years remaining on the lease
- Allocated parking
- Cul-de-sac location
- Direct access to a mature garden
- Central location
- 64.4 sqm/693 sq ft



Energy Efficiency Rating		Current	Potential
<i>Very energy efficient - lower running costs</i>			
(92-100)	A		
(81-91)	B		
(69-80)	C		74
(55-68)	D	62	
(39-54)	E		
(21-38)	F		
(1-20)	G		
<i>Not energy efficient - higher running costs</i>			
England, Scotland & Wales		EU Directive 2002/91/EC	



Viewing strictly by
appointment via
Estate and Agent

CONTACT

Estate and Agent
Hampton Wick
Kingston Upon Thames
KT1 4AY

david@estateandagent.com

Open Hours-
Monday to Friday 8am - 7pm
Saturdays 9am - 5pm
Sundays 10am - 4pm

0208 914 7884

www.estateandagent.com

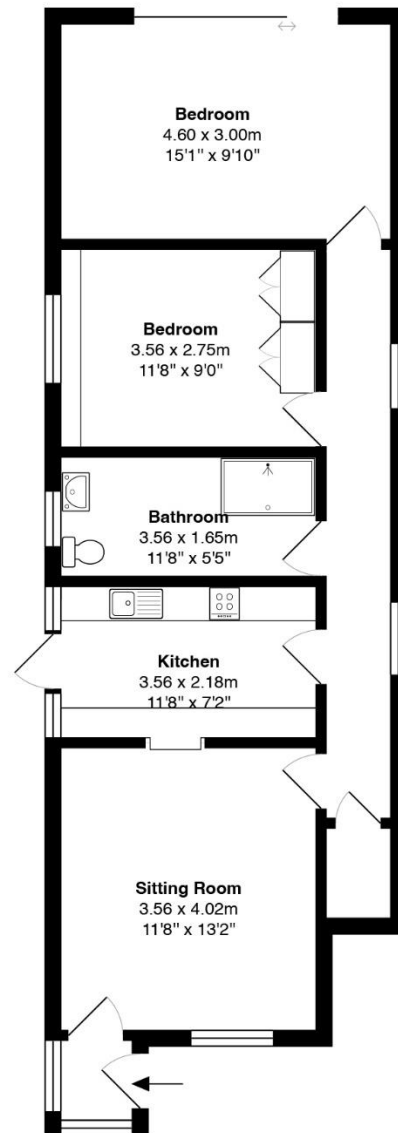

Thelma Grove, Teddington

Total Area: 64.4 m² ... 693 ft²



All measurements
are approximate and for display purposes only

Estate and Agent wish to advise prospective purchasers that we have not checked the services or appliances. The sales particulars have been prepared as guide only; any floor plan or map is for illustrative purposes only. Estates IT, for themselves and for the vendors or lessors of this property whose agents they are given that the particulars have been produced in good faith; do not constitute any part of a contract; no person in the employment of Estate & Agent has any authority to make or give any representation of warranty in relation to this property.