

School Terrace, Dawlish, EX7 9NT



An immaculately presented 2 double bedroom bedroomed modern home offered in excellent decorative order with stylish touches throughout including double glazing and gas central heating. The property also has the advantage of parking.

NO ONWARD CHAIN, COUNCIL TAX BAND - B, EPC - C.

£249,950

01626 862379

www.fraserandwheeler.co.uk

FRASER & WHEELER

FRONT DOOR TO

ENTRANCE HALL

Radiator, coved ceiling, stairs leading to the first floor and door to:

SITTING ROOM

4.60m x 3.13m (15'1" x 10'3")

Double glazed box bay window with deep window sill to the front, radiator, coved ceiling, under stairs storage cupboard housing the central heating boiler and fuse box. Doors to:

CLOAKROOM

Suite comprising WC, wash hand basin, coved ceiling and extractor fan.

KITCHEN

2.95m x 2.45m (9'8" x 8'0")

Base and eye level units with work surfaces over, stainless steel sink with mixer tap, gas hob with oven below, integral fridge/freezer, plumbing for a washing machine, coved ceiling, radiator, window and door leading to the rear courtyard.

FIRST FLOOR LANDING

Coved ceiling, hatch to the loft space and doors to:

BEDROOM 1

4.47m x 2.99m (14'8" x 9'10")

2 windows to the front with open aspect, radiator and coved ceiling.

BEDROOM 2

3.23m x 2.95m (10'7" x 9'8")

2 windows to the rear, coved ceiling and radiator.

BATHROOM

Suite comprising panelled bath with shower and glass screen over, WC, pedestal wash hand basin, radiator, coved ceiling and extractor fan.

OUTSIDE

To the front of the property is a brick paved driveway with steps and path leading to the front door. To the rear is a small courtyard with a further area of garden above which can be accessed by the rear access lane.

AGENTS NOTE

please note the room measurements are to be used as a guide to the irregular shape of the rooms.

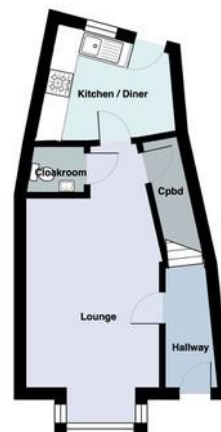

Ground Floor

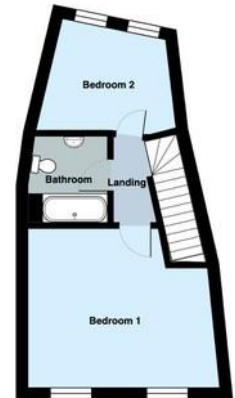

First Floor

19 Queen Street, Dawlish, Devon, EX7 9HB

Telephone: 01 626 862379

Email: info@fraserandwheeler.co.uk

www.fraserandwheeler.co.uk

