

MAPESBURY



Joules House, Christchurch Avenue, Kilburn, NW6 £299,950

- One Bed Top Floor
- Affordable Home
- Opposite Tube
- Entryphone/Lift
- Wooden Floors
- Double-Glazing
- Communal Gardens
- Leasehold

Joules House, Christchurch Avenue, NW6 7QW

Approx Gross Internal Area = 48.9 sq m / 526 sq ft

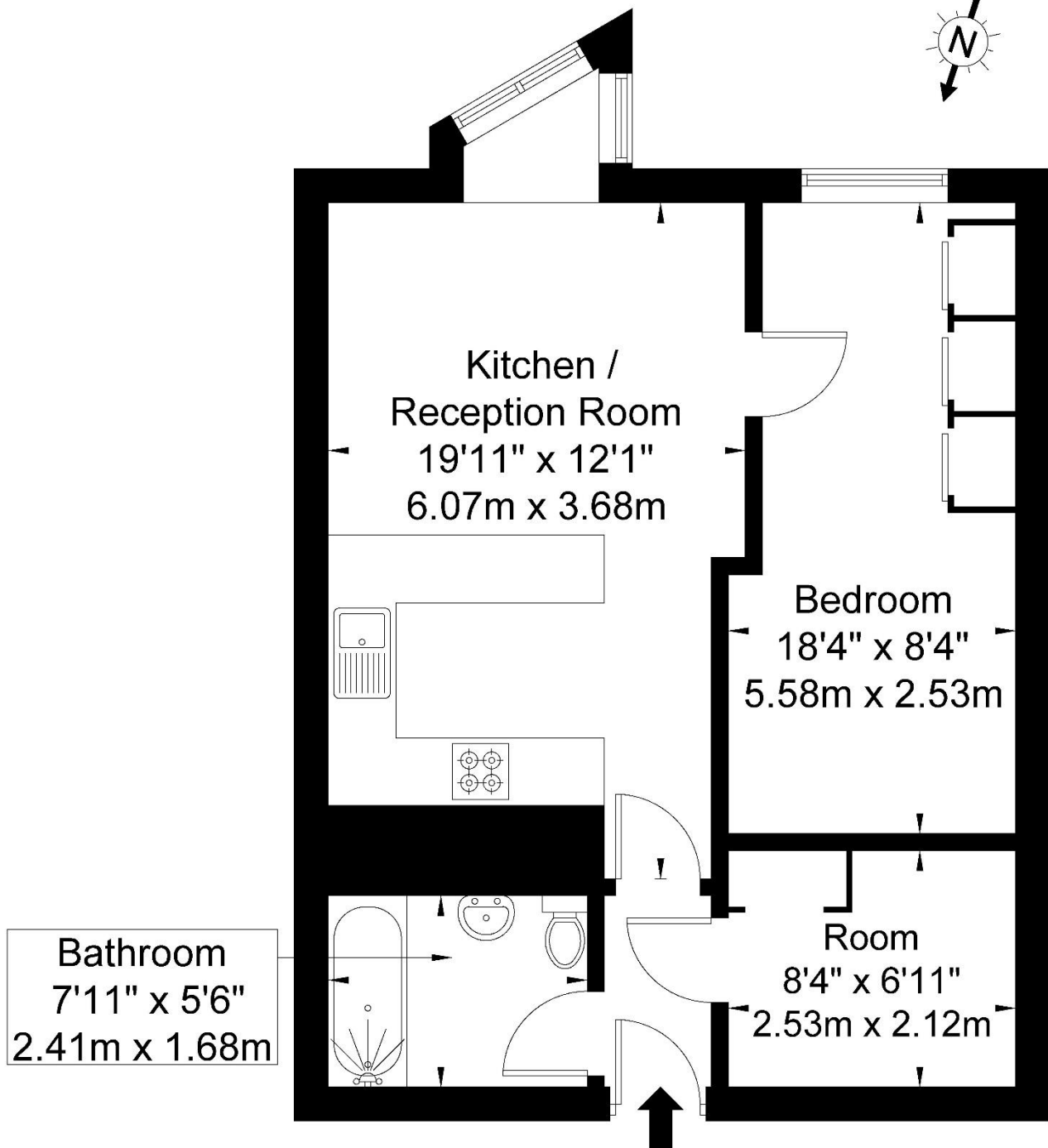
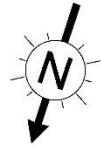

Third Floor

Ref

Copyright **BLEU
PLAN**

The Floor plan is not to scale and measurements and areas shown are approximate and therefore should be used for illustrative purposes only. The plan has been prepared in accordance with the RICS code of Measuring Practice and whilst we have confidence in the information produced it must not be relied on. If there is any aspect of particular importance, you should carry out or commission your own inspection of the property.

Copyright @ BLEUPLAN