



SEYMOURGREEN
AT THE HEART ♥ OF YOUR MOVE

Whitlock Drive, Southfields, London, SW19

- ♥ Ideal Family Home or Rental
- ♥ Freehold
- ♥ Open Plan Living Room
- ♥ Four Bedrooms
- ♥ Wonderful South Facing Garden
- ♥ Unallocated Off Street Parking

A delightful four bedroom freehold house ideally located being just a 7 minute walk from Southfields Station along with Southfields Village with its excellent variety of shops and cafes. The property is well presented throughout comprising open plan living room kitchen, four bedrooms and modern bathroom all complimented by the wonderful 42' South Facing Garden.

For Sale: £575,000



Seymour Green, 483 Merton Road, London SW18 5LE

T: 020 8870 0111 F: 020 3302 9598 E: southfields@seymour-green.co.uk W: seymour-green.co.uk



SEYMOURGREEN
AT THE HEART ♥ OF YOUR MOVE

WHITLOCK DRIVE, SW19

Approx. Gross Internal Floor Area

893 Sq. ft/82.95 Sq. m

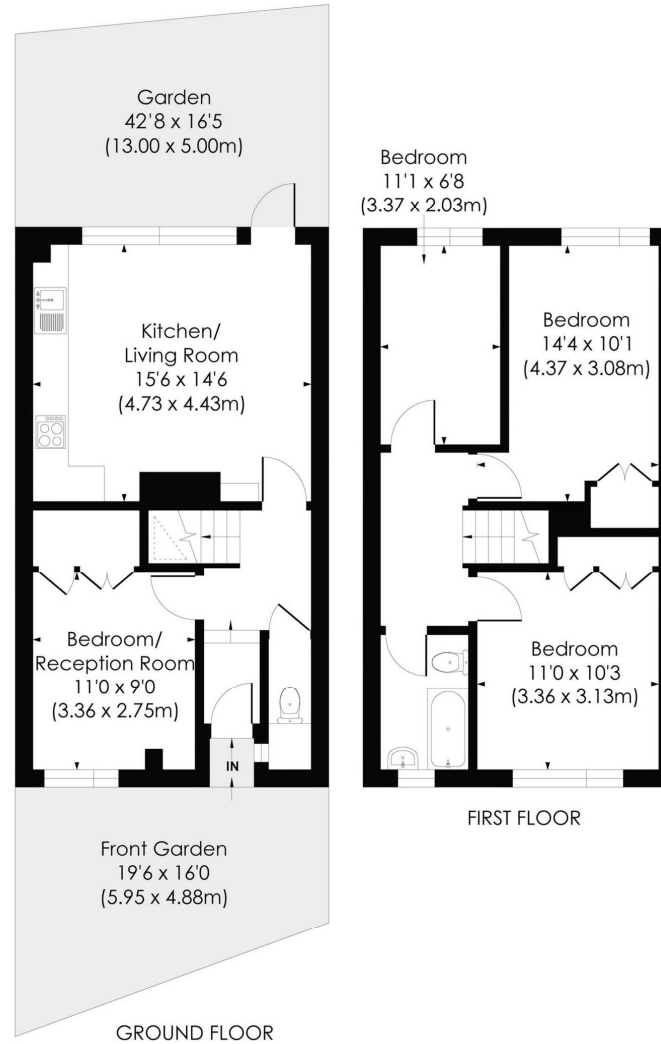

© Pixangle Property Marketing Ltd. info@pixangle.com Tel: 0208 870 2118

pixangle
PROPERTY MARKETING

This floor plan has been prepared for the purpose of illustration only in accordance with the latest RICS code of measuring practice and is not to scale. All measurements and areas are approximate and whilst every effort has been made to ensure the accuracy of the plan contained here, no responsibility is taken for any error, omission or misstatement.



SEYMOURGREEN
AT THE HEART ♥ OF YOUR MOVE

Whitlock Drive, Southfields, London, SW19

For Sale: £575,000



Seymour Green, 483 Merton Road, London SW18 5LE
T: 020 8870 0111 F: 020 3302 9598 E: southfields@seymour-green.co.uk W: seymour-green.co.uk



SEYMOURGREEN
AT THE HEART OF YOUR MOVE

Whitlock Drive, Southfields, London, SW19

For Sale: £575,000

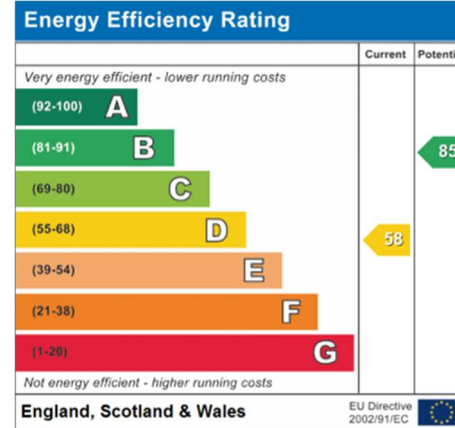
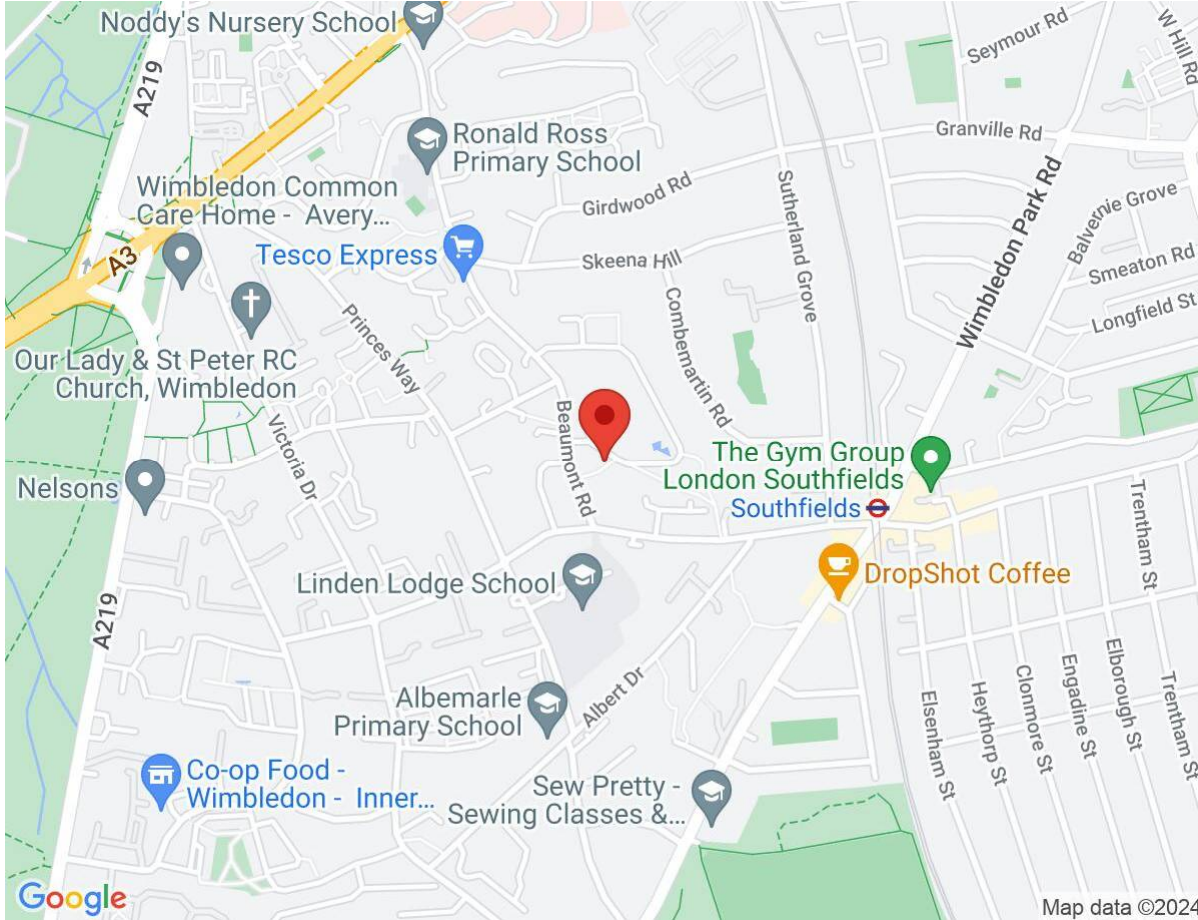

IMPORTANT NOTICE
Descriptions of the property are subjective and are used in good faith as an opinion and NOT as a statement of fact. Please make further specific enquires to ensure that our descriptions are likely to match any expectations you may have of the property. We have not tested any services, systems or appliances at this property. We strongly recommend that all the information we provide be verified by you on inspection, and by your Surveyor and Conveyancer.

Seymour Green, 483 Merton Road, London SW18 5LE
T: 020 8870 0111 F: 020 3302 9598 E: southfields@seymour-green.co.uk W: seymour-green.co.uk