



**SEYMOURGREEN**  
AT THE HEART ♥ OF YOUR MOVE

## Greyhound Parade, Wimbledon, London, SW17

- ♥ No Onward Chain
- ♥ Private Balcony
- ♥ 244 Year Lease
- ♥ Large Living Space
- ♥ Stunning Views
- ♥ Ideal First Time Buy

A Stunning 6th Floor apartment boasting the most amazing views over AFC Wimbledon Stadium, where match days will never be the same! Set within this highly regarded development constructed just over 3 years ago this spacious apartment with large open plan living space and well fitted kitchen with integrated appliances, generous double bedroom, stylish bathroom, good storage and a fabulous balcony would make the ideal first time buy. Millwards Court is very well located with excellent transport facilities with regular bus services to Wimbledon and Tooting, whilst there the more immediate area offers supermarkets, coffee shops and gyms on the door step.



# For Sale: £435,000

Seymour Green, 483 Merton Road, London SW18 5LE

T: 020 8870 0111 F: 020 3302 9598 E: [southfields@seymour-green.co.uk](mailto:southfields@seymour-green.co.uk) W: [seymour-green.co.uk](http://seymour-green.co.uk)



**SEYMOURGREEN**  
AT THE HEART ♥ OF YOUR MOVE

## GREYHOUND PARADE, SW17

Approx. Gross Internal Floor Area

**572 Sq. ft/53.10 Sq. m**

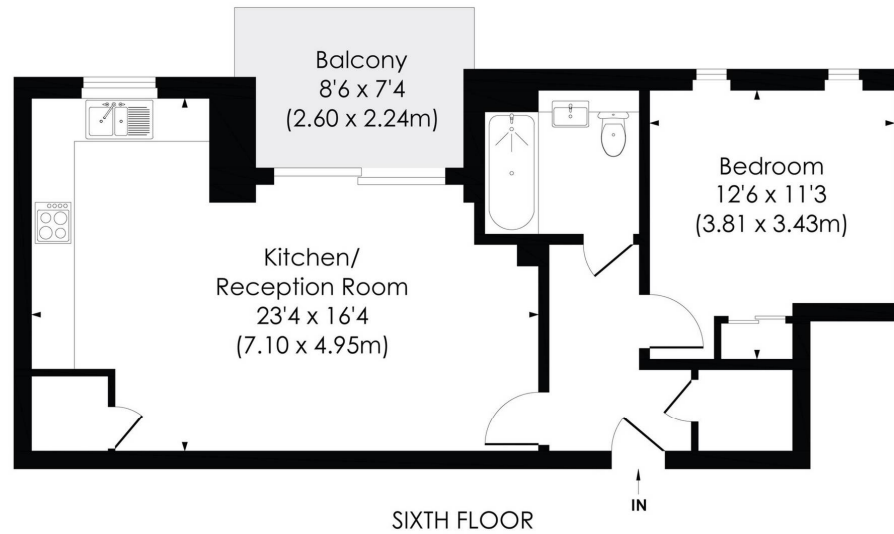

© Pixangle Property Marketing Ltd. info@pixangle.com Tel: 0208 870 2118

**pixangle**  
PROPERTY MARKETING

This floor plan has been prepared for the purpose of illustration only in accordance with the latest RICS code of measuring practice and is not to scale. All measurements and areas are approximate and whilst every effort has been made to ensure the accuracy of the plan contained here, no responsibility is taken for any error, omission or misstatement.



**SEYMOURGREEN**  
AT THE HEART ♥ OF YOUR MOVE

# Greyhound Parade, Wimbledon, London, SW17

## For Sale: £435,000



Seymour Green, 483 Merton Road, London SW18 5LE  
T: 020 8870 0111 F: 020 3302 9598 E: southfields@seymour-green.co.uk W: seymour-green.co.uk





SEYMOURGREEN  
AT THE HEART OF YOUR MOVE

# Greyhound Parade, Wimbledon, London, SW17

## For Sale: £435,000

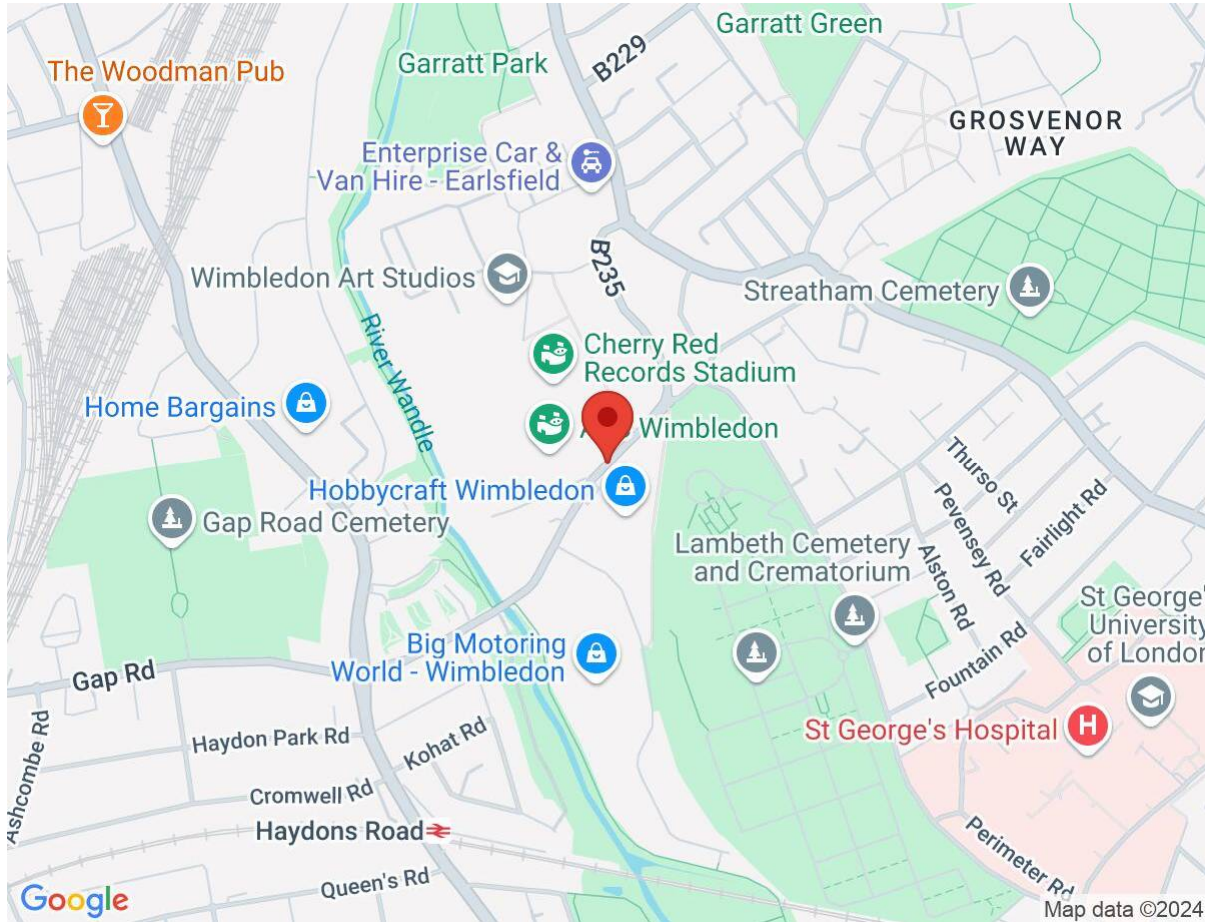

| Energy Efficiency Rating                    |          | Current                 | Potential |
|---|----------|-------------------------|-----------|
| Very energy efficient - lower running costs |          |                         |           |
| (92-100)                                    | <b>A</b> |                         |           |
| (81-91)                                     | <b>B</b> | 84                      | 84        |
| (69-80)                                     | <b>C</b> |                         |           |
| (55-68)                                     | <b>D</b> |                         |           |
| (39-54)                                     | <b>E</b> |                         |           |
| (21-38)                                     | <b>F</b> |                         |           |
| (1-20)                                      | <b>G</b> |                         |           |
| Not energy efficient - higher running costs |          |                         |           |
| England, Scotland & Wales                   |          | EU Directive 2002/91/EC |           |



**IMPORTANT NOTICE**  
Descriptions of the property are subjective and are used in good faith as an opinion and NOT as a statement of fact. Please make further specific enquires to ensure that our descriptions are likely to match any expectations you may have of the property. We have not tested any services, systems or appliances at this property. We strongly recommend that all the information we provide be verified by you on inspection, and by your Surveyor and Conveyancer.

Seymour Green, 483 Merton Road, London SW18 5LE  
T: 020 8870 0111 F: 020 3302 9598 E: southfields@seymour-green.co.uk W: seymour-green.co.uk