



The Knowle |  
Hoddesdon | EN11

## ***Four bedroom town house...d***

*Stones throw from Hoddesdon Town Centre | Walking distance from Broxbourne train station | Low maintenance, good sized garden | DRAFT details | Call for further info | Keys held for viewings*

***Asking price of £2,200 per month***

Welcome to your new home!

VIA Properties are thrilled to present this impressive four-bedroom family residence located in a tranquil cul-de-sac adjacent to the picturesque Barclay Park.

This spacious property spans three floors, offering a wealth of living space and an array of desirable features. Available for rent from end of November, this home is perfect for families seeking a comfortable and convenient living experience.



### **\*\*Key Property Details:\*\***

- **\*\*Availability Date:\*\*** towards end of November
- **\*\*Furnishing:\*\*** Unfurnished
- **\*\*Deposit:\*\*** £2538.46
- **\*\*Rental Term:\*\*** Long term let
- **\*\*Location:\*\*** Town Centre, Close to Train Stations
- **\*\*Property Type:\*\*** Family Home
- **\*\*Garage:\*\*** Internal
- **\*\*Garden:\*\*** Good-sized rear garden



### **\*\*Property Features:\*\***

- **\*\*Spacious Living:\*\*** This property

boasts a generous reception room and four large bedrooms, providing ample space for relaxation and entertaining.

- **Modern Design:** Enjoy contemporary living with a luxury kitchen and bathrooms, ensuring both style and functionality.

- **Convenient Location:** Situated in a prime Town Centre location, this home is within walking distance to the train station, making commuting a breeze.

- **Family-Friendly:** Ideal for families, this residence offers a safe and quiet environment for children, along with proximity to Barclay Park for outdoor activities.

- **Close to Amenities:** Benefit from the convenience of nearby local amenities, ensuring everyday essentials are always within reach.

Don't miss the opportunity to make this beautiful family home yours.

To schedule a viewing or for further inquiries, please contact VIA Properties today.



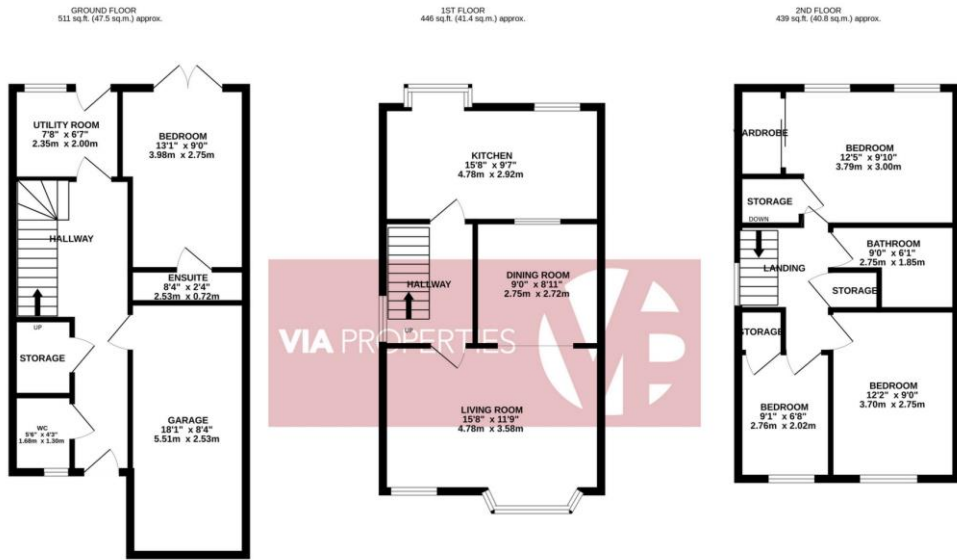

TOTAL FLOOR AREA: 1399 sq.ft. (129.7 sq.m.) approx.

Whilst every attempt has been made to ensure the accuracy of the floorplan contained here, measurements of doors, windows, rooms and any other items are approximate and no responsibility is taken for any error, omission or mis-statement. This plan is for illustrative purposes only and should be used as such by any prospective purchaser. The services, systems and appliances shown have not been tested and no guarantee as to their operability or efficiency can be given.  
Made with Metropix ©2023

## VIA PROPERTIES

74 High Street, Hoddesdon, EN11  
01992443399 | info@viavia.co.uk | www.viavia.co.uk

Important Notice - These particulars have been prepared in good faith and they are not intended to constitute part of an offer or contract. We have not performed a structural survey on this property and the services, appliances and specific fittings have not been tested. All photographs, measurements, floor plans and distances referred to are given as a guide and should not be relied upon.

